

NDA-U-PA2 Surveillance cabinet 230VAC

www.boschsecurity.com



BOSCH
Invented for life



- ▶ Complete power supply and connectivity solution for outdoor use
- ▶ Perfectly matched mechanical interfaces for easy installation on wall, pole or corner
- ▶ Reliable installation with built-in surge protection
- ▶ Weather resistant finish to maintain the cosmetic appearance over the years

Bosch's **Modular Camera Mounts & Accessories** offer a modular range of camera mounts, mounting adapters, camera interface plates and surveillance cabinets. All items are easy to handle and simplify the installations of our cameras across a wide range of applications to suit all of your needs. The mechanical design is extremely robust and suitable for any environment, both indoor and outdoor. The accessories are designed with usability in mind. It's modern and sleek design is a perfect combination of form and function.

Functions

The surveillance cabinets are specially designed to meet the requirements of the security and surveillance market. The surveillance cabinets provide a power supply for situations without PoE. It is available without a transformer (for direct 24 VAC power input) and with either a 120 VAC or a 230 VAC transformer for mains supply. Each surveillance cabinet offers 100 W output with surge protection. The surveillance cabinet, when used with compatible mount and camera, offers full IP66 and IK10 rated. You can use it as a safe, robust and watertight box in which you can

make your connections or install extra hardware. For more details about compatibility, refer to the Product Selector.

Universal accessory combinations

You can mount this accessory directly to a wall or ceiling, or use one of these accessories for pole or corner mounting:

- NDA-U-PMAL Pole mount adapter large
- NDA-U-CMT Corner mount adapter

On this accessory you can mount:

- NDA-U-WMT Pendant wall mount
- NDA-U-PMT Pendant ceiling mount

Certifications and approvals

Environmental		
Salt mist	IEC60068-2-52	
Impact	IK10	
Ingress Protection	IP66	
Region	Regulatory compliance/quality marks	
Europe	CE	NDA-U-PAx

Parts included

Quantity	Component
1	Surveillance cabinet 230VAC
1	Quick Installation Guide
1	Safety manual
1	EAC document

Technical specifications

Mechanical

Dimensions (W x H x D)	170.0 mm x 216.4 mm x 105.0 mm (6.69 in. x 8.52 in. x 4.13 in.)
Weight	3773 g (8.32 lb)
Standard Color	White (RAL 9003)
Construction Material	Aluminum alloy
Mounting	To a wall

Electrical

Surge protection on power output	Peak current 21.4 A, peak power 1500 W (10/1000 μ s)
----------------------------------	---

Dimensions in mm (inch)

Ordering information

NDA-U-PA2 Surveillance cabinet 230VAC

Power supply box with a 230 VAC transformer, IP66
Order number **NDA-U-PA2**

Accessories

NDA-U-WMT Pendant wall mount

Universal wall mount for dome cameras, white
Order number **NDA-U-WMT**

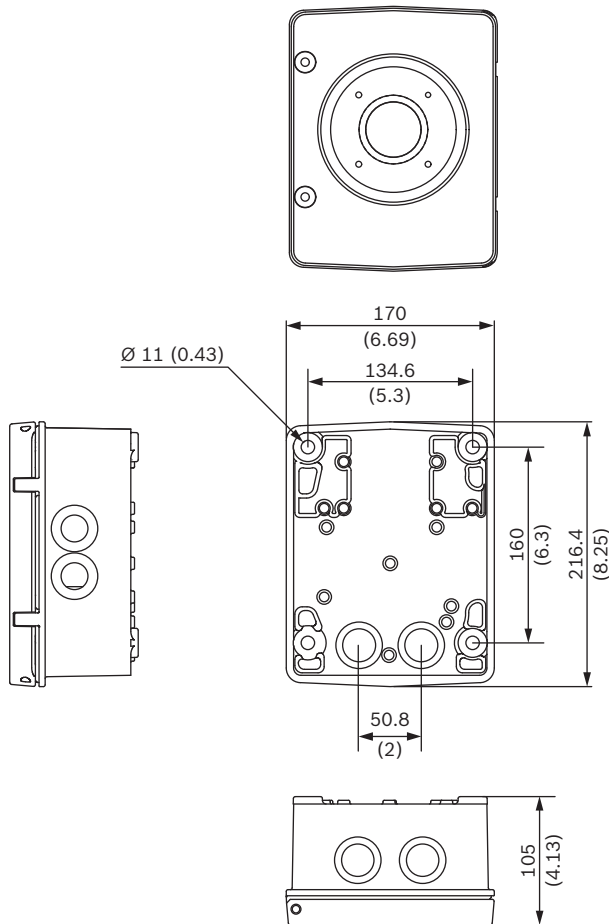

Represented by:

Europe, Middle East, Africa:
Bosch Security Systems B.V.
P.O. Box 80002
5600 JB Eindhoven, The Netherlands
Phone: + 31 40 2577 284
emea.securitysystems@bosch.com
emea.boschsecurity.com

Germany:
Bosch Sicherheitssysteme GmbH
Robert-Bosch-Ring 5
85630 Grasbrunn
Germany
www.boschsecurity.com

North America:
Bosch Security Systems, Inc.
130 Perinton Parkway
Fairport, New York, 14450, USA
Phone: +1 800 289 0096
Fax: +1 585 223 9180
onlinehelp@us.bosch.com
www.boschsecurity.us

Asia-Pacific:
Robert Bosch (SEA) Pte Ltd, Security Systems
11 Bishan Street 21
Singapore 573943
Phone: +65 6571 2808
Fax: +65 6571 2699
apr.securitysystems@bosch.com
www.boschsecurity.asia